



OAKFIELD



Forge Close, Uckfield TN22 5BQ

Asking Price £550,000



Forge Close, Uckfield TN22 5BQ

Price Guide of £550,000 - £575,000

This attractive gable-fronted and part tile hung family home offers a superb blend of character, space, and contemporary living, positioned in a highly sought-after location close to Uckfield town centre and the popular Victoria Park.

Immaculately presented throughout, the property features a welcoming entrance hall that leads into a spacious lounge, complete with a charming log burner — perfect for cosy evenings. The heart of the home is the stylish open-plan kitchen and dining area, designed with both functionality and aesthetics in mind.

This superb space is ideal for entertaining, offering generous room for socialising with family and friends, alongside high-quality fittings and ample natural light.

In addition to the generous living spaces, the ground floor also includes a versatile study, ideal for remote working, and a stunning tile-roofed conservatory that opens onto the rear garden, creating a seamless connection between indoor and outdoor living.

Upstairs, the property continues to impress with four well-balanced bedrooms. The principal bedroom boasts its own dressing room and a sleek, modern en-suite shower room, while the remaining bedrooms are served by a beautifully appointed luxury family bathroom.

Externally, the home benefits from ample off-road parking and an integral garage, offering both convenience and additional storage. The rear garden provides a private and peaceful retreat, perfect for families and those who enjoy outdoor entertaining.

Located within walking distance of Uckfield's vibrant town centre, with its range of shops, schools, restaurants, and excellent transport links, this property presents a rare opportunity to acquire a turn-key family home in a prime location.

Viewing is highly recommended to fully appreciate all that this exceptional property has to offer.





Sitting Room

19'1 x 12'2 (5.82m x 3.71m)

Kitchen/Breakfast Room

19'1 x 11'7 (5.82m x 3.53m)

Study

12'2 x 8'0 (3.71m x 2.44m)

Conservatory

12'4 x 9'4 (3.76m x 2.84m)

Garage

16'1 x 8'9 (4.90m x 2.67m)

Bedroom

12'10 x 11'1 (3.91m x 3.38m)

Bedroom

11'7 x 8'9 (3.53m x 2.67m)

Bedroom

9'7 x 9'6 (2.92m x 2.90m)

Bedroom

12'9 x 12'0 (3.89m x 3.66m)

Council Tax Band - E £3,188 per annum



Floor Plan

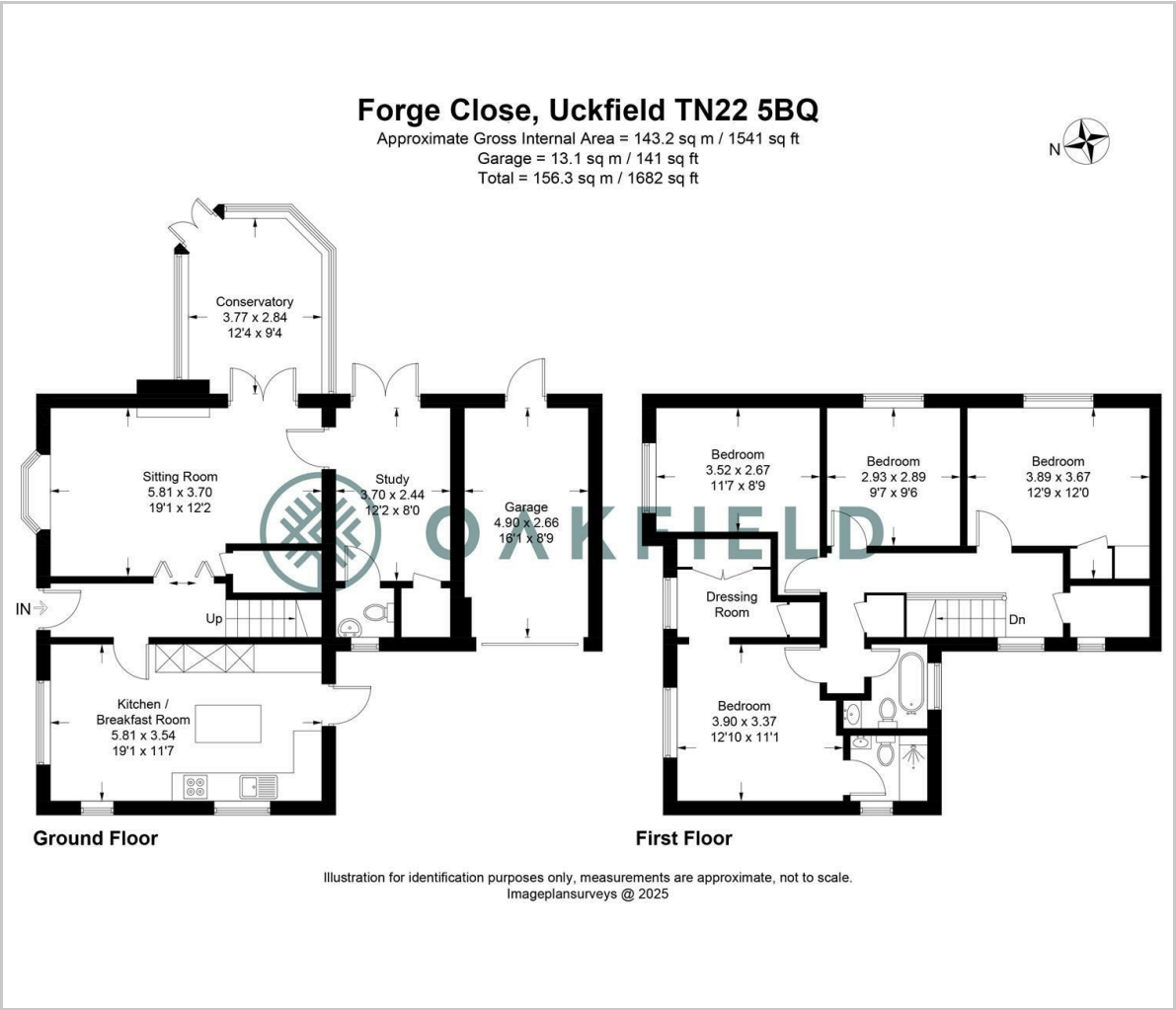

Viewing

Please contact us on 01825 762132
if you wish to arrange a viewing appointment for this property or require further information.

These particulars, whilst believed to be accurate are set out as a general outline only for guidance and do not constitute any part of an offer or contract. Intending purchasers should not rely on them as statements of representation of fact, but must satisfy themselves by inspection or otherwise as to their accuracy. No person in this firms employment has the authority to make or give any representation or warranty in respect of the property.

Area Map



Energy Efficiency Graph

